

— SAN MATEO COUNTY —
CALIFORNIA VOTER'S CHOICE ACT

**ADDITIONS TO THE APPENDIX TO
THE SUPPLEMENT
TO JANUARY 2020 TO JANUARY 2024
ELECTION ADMINISTRATION PLAN
FOR THE NOVEMBER 3, 2020 ELECTION**



OFFICE OF MARK CHURCH
CHIEF ELECTIONS OFFICER & ASSESSOR-COUNTY CLERK-RECORDER

REGISTRATION & ELECTIONS DIVISION

40 Tower Road, San Mateo, CA 94402

phone 650.312.5222 **fax** 650.312.5348

email registrar@smcacre.org **web** www.smcvote.org

  @smcvote

This page intentionally left blank

Vote Center and Drop Box locations

Vote Center Locations

30-Day Vote Centers: Weekdays, October 5 to November 3; Weekend, October 31 to November 1

Redwood City	Assessor-County Clerk-Recorder	555 County Center
San Mateo	Registration & Elections Division	40 Tower Road
South San Francisco	Main Library	840 West Orange Avenue

4-Day Vote Centers: October 31 to November 3

Atherton	Menlo College, El Camino Hall	1000 El Camino Real
Belmont	Notre Dame de Namur University, Taube Center	1500 Ralston Avenue
Brisbane	City Hall, Council Chambers	50 Park Place
Burlingame	St. Paul's Episcopal Church, Foote Hall	415 El Camino Real
Colma	Community Center, Banquet Hall	1520 Hillside Boulevard
Daly City	Bayshore Community Center, Gymnasium	450 Martin Street
Daly City	Jefferson Union High School District, Galleria	699 Serramonte Boulevard
Daly City	Lincoln Park Community Center	901 Brunswick Street
Daly City	Pacelli Event Center, Gymnasium	145 Lake Merced Boulevard
Daly City	War Memorial Community Center, Gymnasium	6655 Mission Street
East Palo Alto	Lewis and Joan Platt East Palo Alto Family YMCA	550 Bell Street
East Palo Alto	Saint Francis of Assisi Church	1425 Bay Road
Foster City	Community Center	1000 East Hillsdale Boulevard
Foster City	William E. Walker Recreation Center, Lagoon Room	650 Shell Boulevard
Half Moon Bay	Emergency Operations Center	537 Kelly Avenue
Hillsborough	Town Hall	1600 Floribunda Avenue
Menlo Park	Arrillaga Family Recreation Center, Sequoia Room	700 Alma Street
Menlo Park	Onetta Harris Community Center, Multipurpose Room	100 Terminal Avenue
Menlo Park	Residence Inn, Menlo Atherton Room	555 Glenwood Avenue
Millbrae	Community Center	623 Magnolia Avenue
Moss Beach	The Church of Jesus Christ of Latter Day Saints, Gymnasium	475 California Avenue
Pacifica	Council Chambers	2212 Beach Boulevard
Pacifica	St. Peter Parish	700 Oddstad Boulevard
Portola Valley	Town Center, Community Hall	765 Portola Road
Redwood City	American Legion Post 105	651 El Camino Real
Redwood City	City Hall, Council Chambers	1017 Middlefield Road
Redwood City	Fair Oaks Branch Library	2510 Middlefield Road
Redwood City	County Law Library	710 Hamilton Street
Redwood City	County Office of Education, California Suite	101 Twin Dolphin Drive
San Bruno	Courtyard by Marriott San Francisco Airport	1050 Bayhill Drive
San Bruno	Skyline College, Building 12, Farallon Room	3300 College Drive
San Bruno	Veteran's Memorial Recreation Center	251 City Park Way
San Carlos	Mahany Hall	1336 Arroyo Avenue
San Carlos	Peninsula Masonic Lodge #168	1150 Arroyo Avenue
San Carlos	Library, Community Room	610 Elm Street
San Mateo	Beresford Recreation Center, Dance Room	2720 Alameda de las Pulgas
San Mateo	Congregational Church of San Mateo	225 Tilton Avenue
San Mateo	County Event Center West Parking Lot, Sequoia Hall	2495 South Delaware Street
San Mateo	Main Library, Oak Room	55 West 3rd Avenue
South San Francisco	Joseph A. Fernekes Recreation Building	781 Tennis Drive
South San Francisco	Conference Center, Oyster Point Room	255 South Airport Boulevard
Woodside	Village Church	3154 Woodside Road

Mobile Vote Center Locations

Daly City	October 10 to 14	9 a.m. - 5 p.m.	Serramonte Center
Half Moon Bay	October 15 to 19	9 a.m. - 5 p.m.	Half Moon Bay Airport
Daly City	October 20 to 24	9 a.m. - 5 p.m.	Cow Palace
Pescadero	October 25 to 29	9 a.m. - 5 p.m.	Pescadero High School
San Mateo	October 30 to November 2 November 3	9 a.m. - 5 p.m. 7 a.m. - 8 p.m.	Hillsdale Shopping Center

Pop-Up Vote Center Locations

East Palo Alto	November 2	9 a.m. - 5 p.m.	East Palo Alto Academy, Multi-Purpose Room	1050 Myrtle Street
East Palo Alto	November 3	7 a.m. - 8 p.m.	East Palo Alto Academy, Multi-Purpose Room	1050 Myrtle Street
La Honda	November 3	7 a.m. - 8 p.m.	La Honda Fire Brigade	8945 La Honda Road
Pescadero	November 3	7 a.m. - 8 p.m.	La Honda-Pescadero Unified School District Office	360 Butano Cutoff

Drop Box Locations

Atherton	Town Administrative Offices (inside)	150 Watkins Avenue
Belmont	City Hall (outside)	1 Twin Pines Lane
Belmont	Library (outside)	1110 Alameda de las Pulgas
Brisbane	City Hall (outside)	50 Park Place
Colma	Community Center (inside)	1520 Hillside Boulevard
Burlingame	Burlingame School District (outside)	1825 Trousdale Drive
Burlingame	City Hall (outside)	501 Primrose Road
Burlingame	Temporary Recreation Center (outside)	1010 Burlingame Avenue
Colma	Town Hall (outside)	1198 El Camino Real
Daly City	City Hall (outside)	333 90th Street
East Palo Alto	Government Center (outside)	2415 University Avenue
East Palo Alto	Ravenswood City School District (inside)	2120 Euclid Avenue
East Palo Alto	University Circle (inside)	1900 University Avenue
Foster City	City Hall (outside)	610 Foster City Boulevard
Half Moon Bay	City Hall (outside)	501 Main Street
Half Moon Bay	New Leaf Community Market (inside)	150 San Mateo Road (Highway 92)
Hillsborough	Town Hall (outside)	1600 Floribunda Avenue
La Honda	Fire Brigade (outside)	8945 La Honda Road
Menlo Park	City Hall (outside)	701 Laurel Street
Menlo Park	Onetta Harris Community Center (outside)	100 Terminal Avenue
Millbrae	City Hall (outside)	621 Magnolia Avenue
Pacifica	City Hall (outside)	170 Santa Maria Avenue
Pescadero	Fire Station 59 (outside)	1200 Pescadero Creek Road
Portola Valley	Town Hall (outside)	765 Portola Road
Redwood City	555 County Center (outside)	Middlefield Road (at Bradford Street)
Redwood City	Assessor-Clerk-Recorder (inside)	555 County Center
Redwood City	City Hall (outside)	1017 Middlefield Road
Redwood City	Community Activities Building (outside)	1400 Roosevelt Avenue
San Bruno	City Hall (outside)	570 Linden Avenue
San Bruno	Senior Center (outside)	1555 Crystal Springs Road (side of bldg.)
San Carlos	City Hall Dog Park (outside)	1401 San Carlos Avenue
San Carlos	Library (inside)	610 Elm Street
San Mateo	City Hall (outside)	330 West 20th Avenue
San Mateo	Dr. Martin Luther King Jr., Community Ctr (outside)	725 Monte Diablo Avenue
San Mateo	Main Library (inside)	55 West 3rd Avenue
San Mateo	Marina Branch Library (outside)	1530 Susan Court
San Mateo	Registration & Elections Division (inside and outside)	40 Tower Road
South San Francisco	City Hall (outside)	400 Grand Avenue
South San Francisco	Main Library (outside)	840 West Orange Avenue
Woodside	Town Hall (outside)	2955 Woodside Road

Vote Center layouts

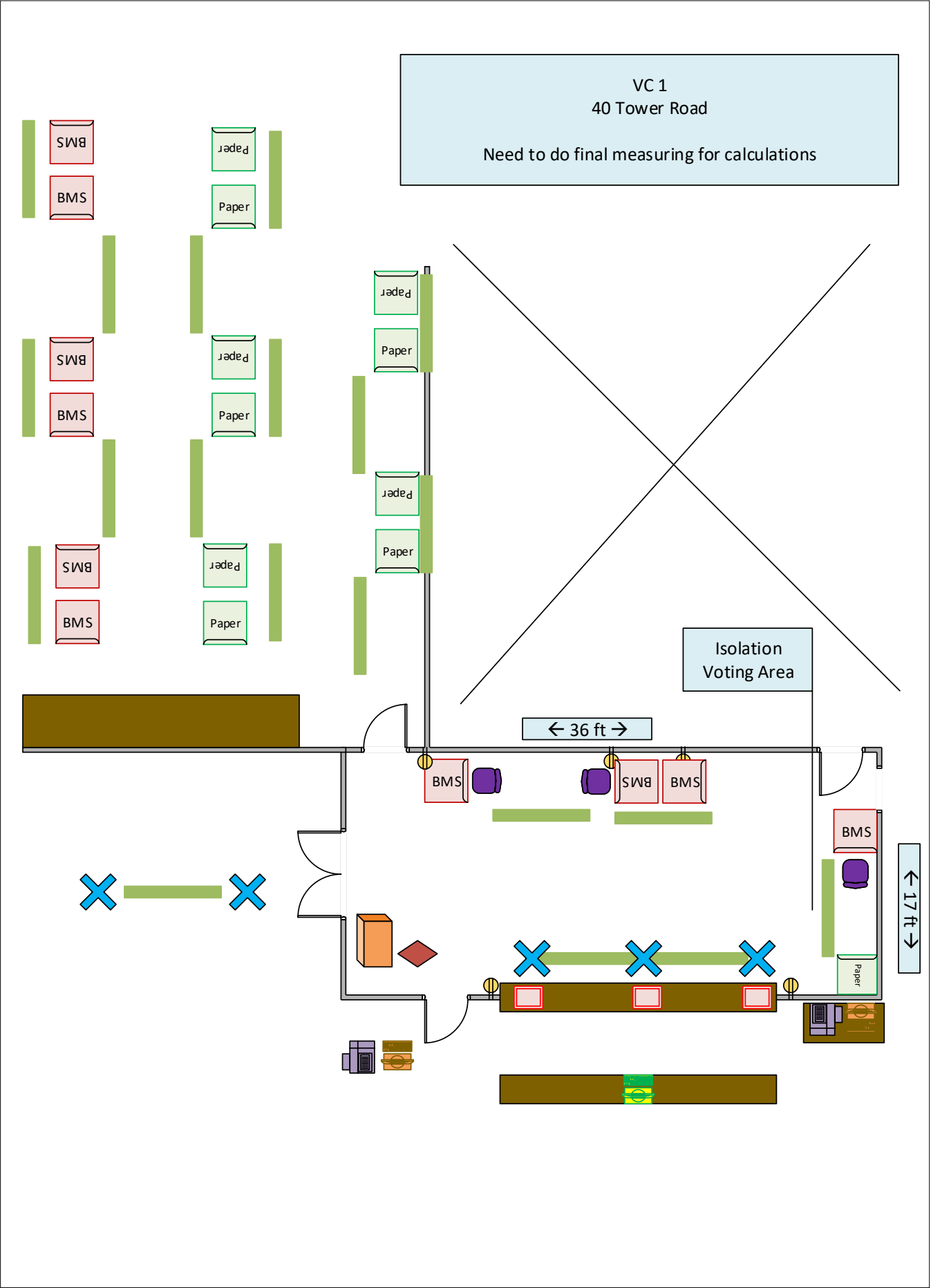

Vote Center layouts

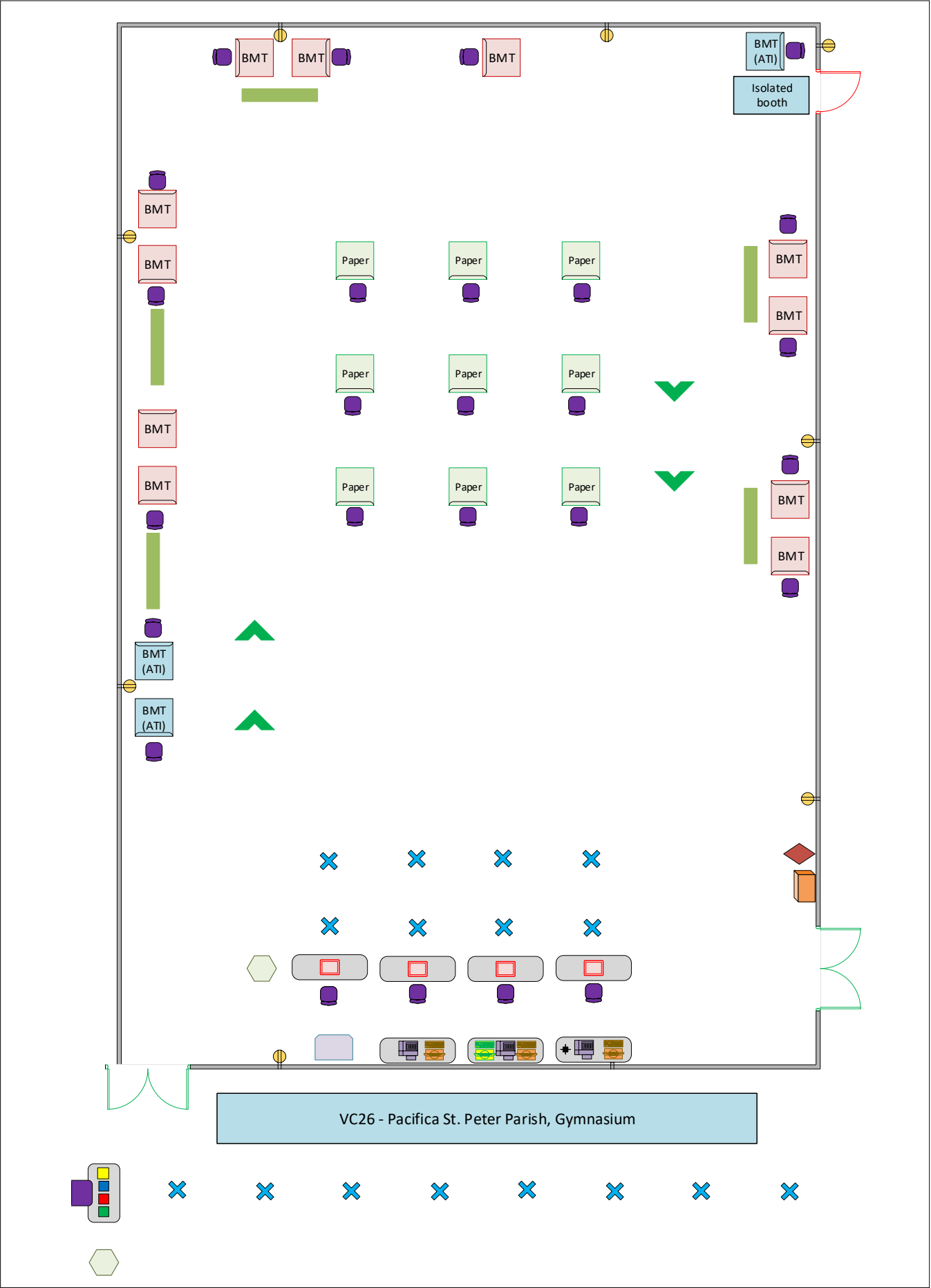

Vote Center layouts

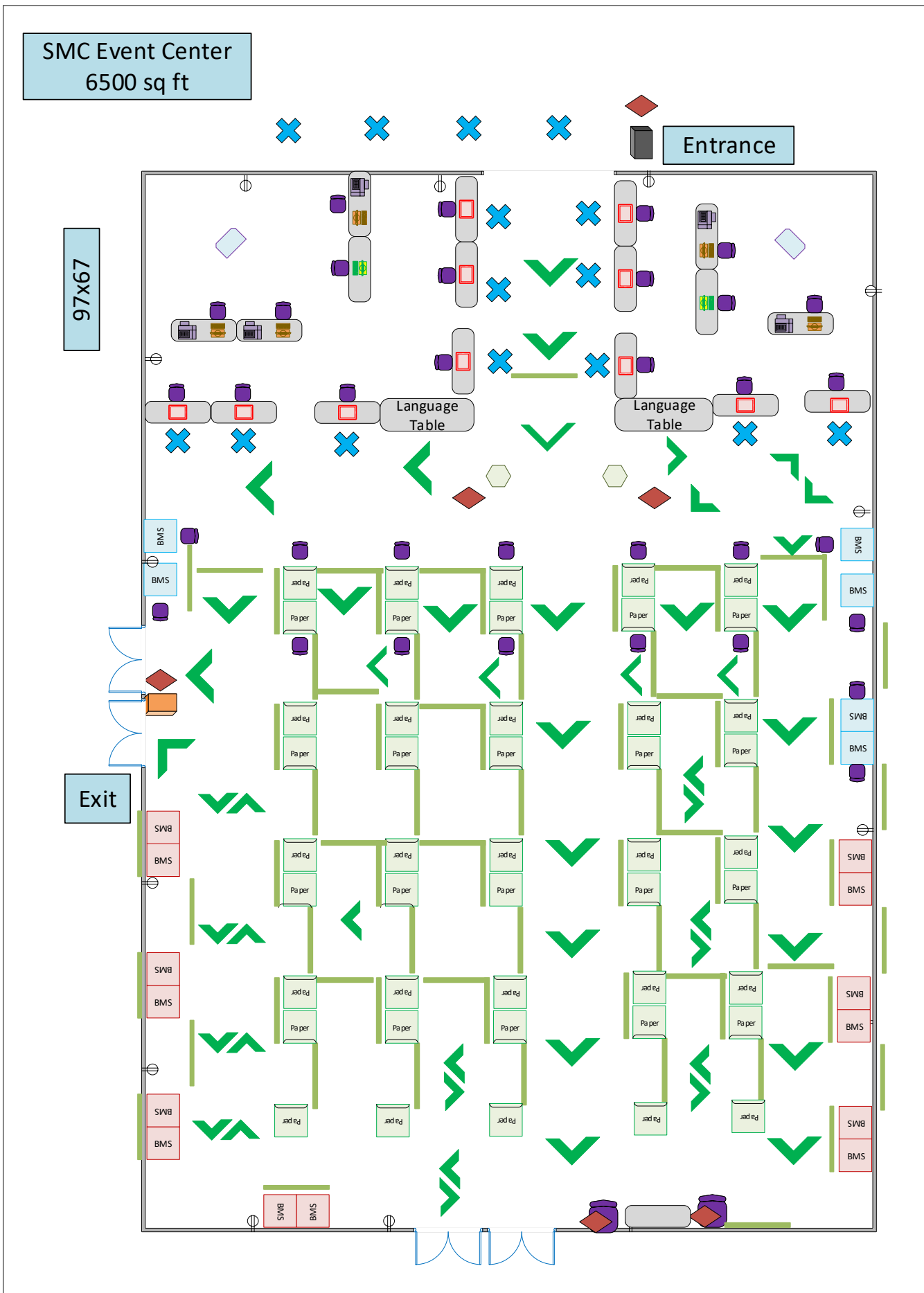

Community Partner Additions

Supervisory District 2

	Phone	E-mail Address
Bay Area Community Health Advisory Council	650.652.3884	aachacsanmateo@gmail.com

Supervisory District 5

Healthways	650.746.3316	healthwaysdc@gmail.com
------------	--------------	------------------------

Throughout County/Out of County

One Myanmar Community	510.936.0939	ksoe@OneMyanmarCommunity.com
-----------------------	--------------	------------------------------

Community Events

2020 Calendar Additions

September 17	Operation: Education, Mobilization & Registration
October 1	Brisbane City Council
October 8	Sunset Rotary Club
October 13	Millbrae City Council
October 14	South San Francisco City Council
October 20	San Mateo Theta Alumnae: Behind the Scenes in a Presidential Election

Media Partners Additions

Newspapers

- Foster City Islander (English)
- India Post (English)
- Myanmar Gazette (Burmese)
- Nextdoor (English)
- Nichi Bei (Japanese)
- Nikkei West (Japanese)

Example: Direct Voter Contact

Postcard 1



OFFICE OF MARK CHURCH
CHIEF ELECTIONS OFFICER & ASSESSOR-COUNTY CLERK-RECORDER
REGISTRATION & ELECTIONS DIVISION

November 3, 2020 Presidential General Election

MORE DAYS, MORE WAYS TO VOTE!

Commencing October 5, 2020, ballots for the November 3, 2020 Presidential General Election will be mailed to all registered voters. As a leader in California Vote-by-Mail Elections, San Mateo County has established the highest standards of excellence for Vote-by-Mail Elections. Voting by mail is safe, secure and convenient in this COVID-19 environment. Voters may vote from the safety and convenience of their homes, vote in person at one of our 45 Vote Centers or use our new Remote Accessible Vote-by-Mail Ballot system. For more information on new voter services and our COVID-19 preparations, please visit www.smcvote.org or call **650.312.5222**.

Ways to vote:

 **Vote by Mail**



 **Vote in Person**

 **Remote Accessible
Vote-by-Mail Ballot system**

October 5 to October 30*	Three Vote Centers in North, Central and South County will be open weekdays, 9 a.m. to 5 p.m.
October 31 to November 2	Forty-five Vote Centers will be open daily, 9 a.m. to 5 p.m.
November 3	All forty-five Vote Centers will be open, 7 a.m. to 8 p.m.

Important: Since many jurisdictions have moved to District Elections, your local representative's name may not be on your ballot. Please check with your City, School or Special District for details.

**Vote Centers will be closed on Columbus Day, Monday, October 12, 2020.*

Visit www.smcvote.org or   [@smcvote](https://www.instagram.com/smcvote)
Call or Text: **650.312.5222**

Postcards sent in English, Spanish and Chinese based on voter's language preference selected on their voter registration form.

REGISTRATION & ELECTIONS DIVISION

MORE DAYS, MORE WAYS TO VOTE!



Vote Centers will be closed on Columbus Day, Monday, October 12, 2020.

Visit www.smcvote.org or   @smcvote
Call or Text: 650.312.5222



OFFICE OF MARK CHURCH
CHIEF ELECTIONS OFFICER & ASSESSOR-COUNTY CLERK-RECORDER
REGISTRATION & ELECTIONS DIVISION

November 3, 2020 Presidential General Election

All voting options will follow COVID-19 health protocols.

There is still time to **return your ballot!** You can mail your ballot in the postage-paid envelope, drop it off at a secure Ballot Drop Box or go to any accessible Vote Center by 8 p.m. on November 3.

If you choose to return your voted ballot by mail, it must be **postmarked by Election Day, Tuesday, November 3, 2020**, and received no later than November 20, 2020 in order to be accepted.

Didn't get a ballot? Need a new one? Need to update your address or know someone who needs to register?
Contact our office today to have a replacement ballot mailed to you.

Sign up to receive automated alerts on the status of your ballot at wheresmyballot.sos.ca.gov.

Don't Delay. Vote Today!

Visit www.smcvote.org or   @smcvote
Call or Text: 650.312.5222